

# Blower Impeller Replacement

## OWNER'S MANUAL

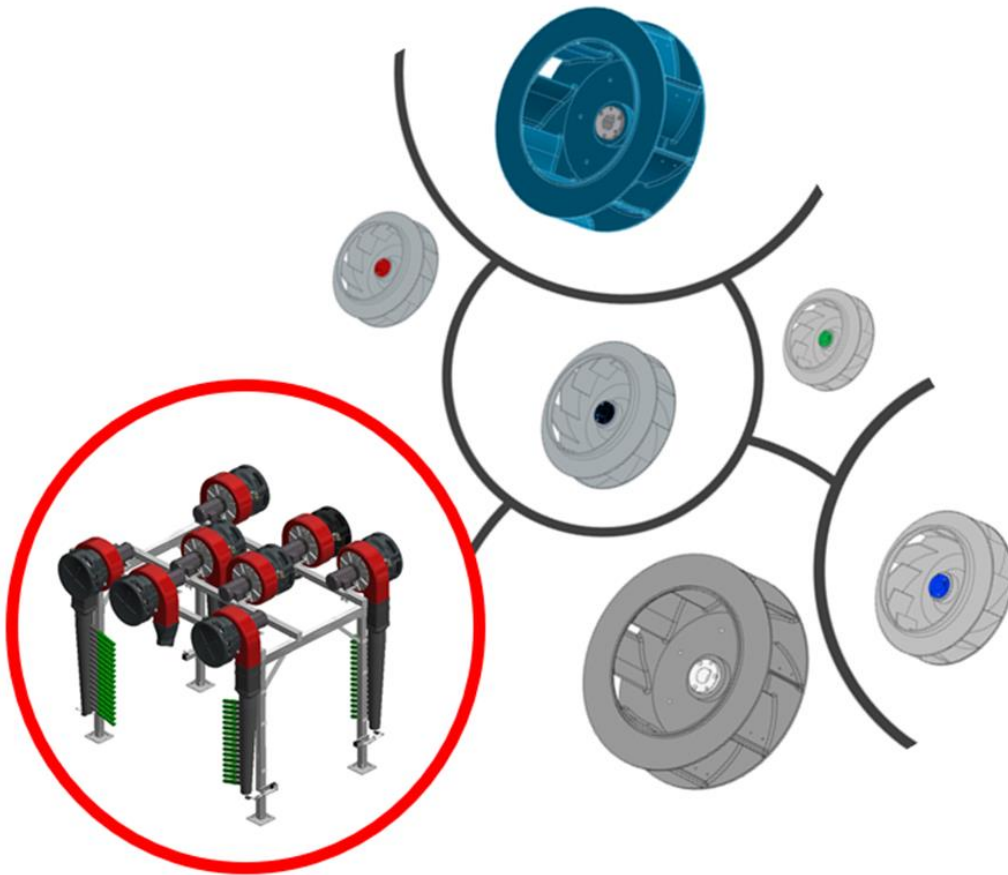

[View all Sonny's  
Product Manuals &  
Technical Bulletins](#)



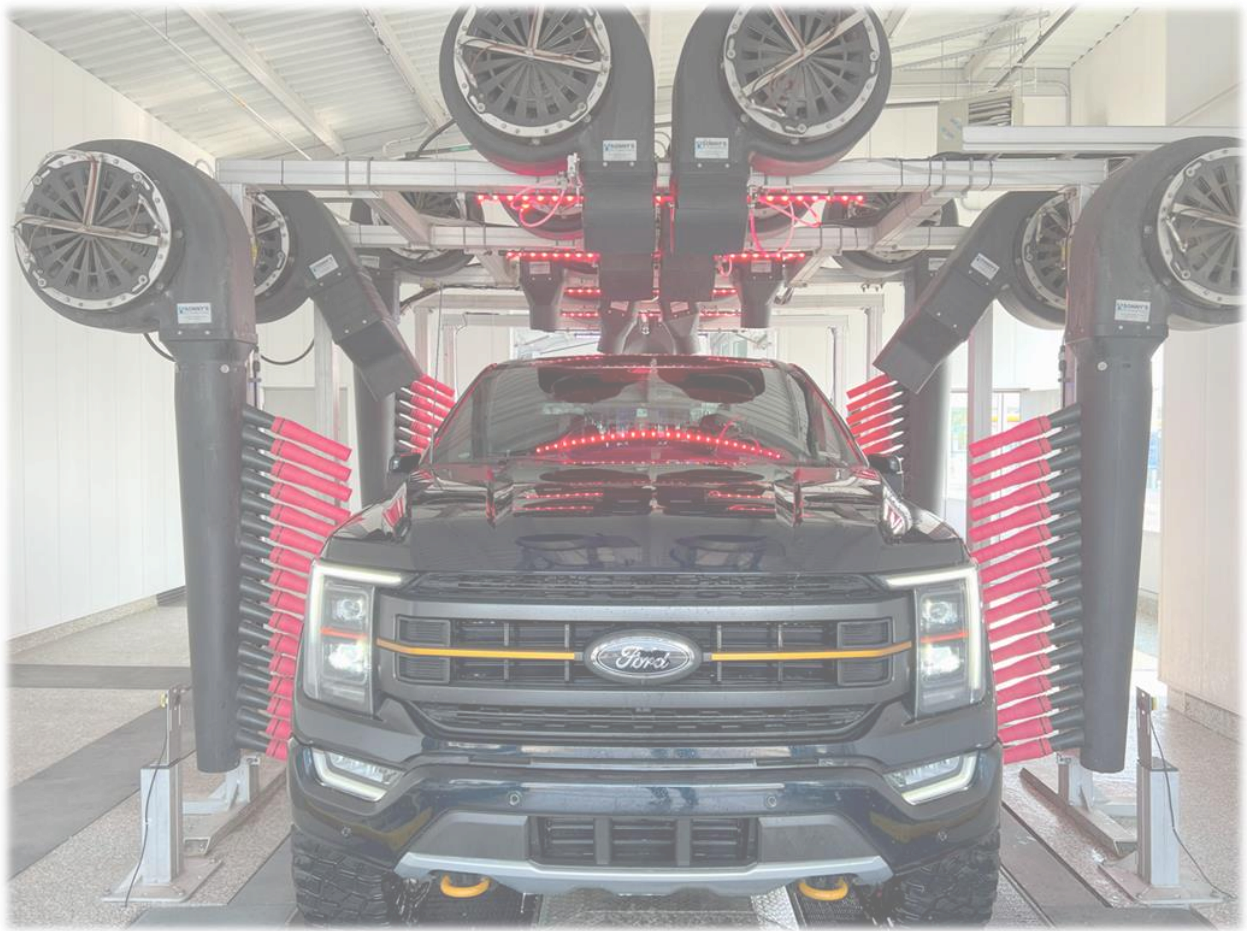

All trademarks, service marks, and logos registered to Sonny's Enterprises LLC are protected intellectual property. Products mentioned herein are for identification purposes only and may be registered trademarks of their respective companies. All other brand names, trademarks or registered trademarks are the property of their respective owners.

# TABLE OF CONTENTS

<b>1. READ ALL INSTRUCTIONS PRIOR TO OPERATING</b>	
1.1 CHECKLIST.....	5
1.2 RECOMMENDED PPE.....	5
1.3 PRECAUTIONS.....	5
1.4 IMPORTANT SAFEGUARDS AND WARNINGS.....	6
1.5 SAFETY FIRST .....	8
1.6 HOW TO MAKE A SAFE WORKPLACE .....	9
1.7 LADDER SAFETY.....	9
1.8 OWNER'S MANUAL UPDATES .....	10
<b>2. BLOWER IMPELLER REPLACEMENT FEATURES</b>	
2.1 INTRODUCTION .....	11
2.2 EQUIPMENT SPECIFICATIONS.....	12
<b>3. UTILITY REQUIREMENTS</b>	
3.1 UTILITIES.....	13
<b>4. INSTALLATION INSTRUCTIONS</b>	
4.1 SAFETY WEAR REQUIRED FOR INSTALLATION.....	14
4.2 EQUIPMENT REQUIRED FOR INSTALLATION .....	14
4.3 TOOLS REQUIRED FOR INSTALLATION.....	14
4.4 BLOWER IMPELLER REPLACEMENT DOCUMENTS.....	14
4.5 INSTALLATION IMPELLER OPTIONS .....	15
4.6 INSTALLATION IMPELLER OPTIONS .....	16
4.7 BEFORE STARTING .....	17
4.8 REMOVE – BLOWER SILENCER OPTIONAL.....	18
4.9 REMOVE – AEROGATE AND VENTURI .....	18
4.10 REMOVE – VENTURI .....	19
4.11 REMOVE – GATOR .....	19
4.12 REMOVE – IMPELLER.....	20
4.13 INSTALL NEW IMPELLER .....	24
4.14 INSTALL AEROGATE AND VENTURI.....	26
4.15 INSTALL VENTURI .....	26
4.16 INSTALL BLOWER SILENCER OPTIONAL.....	27
4.17 INSTALL GATOR.....	27
4.18 REMOVE LOCK-OUT TAG-OUT.....	28

## BLOWER IMPELLER REPLACEMENT OWNER'S MANUAL

# TABLE OF CONTENTS

<b>5. MAINTENANCE</b>	
5.1 DAILY .....	29
5.2 MONTHLY .....	29
5.3 ANNUALLY .....	29
<b>6. ONLINE SERVICES</b>	
6.1 SHOP .....	30
6.2 QUICK ORDER .....	30
6.3 TRACK ORDER .....	30
6.4 SALES .....	30
6.5 SERVICES & SUPPORT .....	30
<b>7. WEAR ITEMS AND REPLACEMENT PARTS</b>	
7.1 COUNTERCLOCKWISE IMPELLERS – FROM MOTOR SIDE .....	31
7.2 CLOCKWISE IMPELLERS – FROM MOTOR SIDE .....	32
<b>8. CONTACT US</b>	
8.1 TECHNICAL SUPPORT .....	33
8.2 REPLACEMENT PARTS .....	33
8.3 SCHEDULE ON-SITE SERVICE AND SUPPORT .....	33
8.4 EMERGENCY CELL PHONE CONTACTS .....	33

For Warranty Go To: <https://sonnysdirect.com/warranty>

**THANK YOU FOR BEING A SONNY'S CAR WASH EQUIPMENT OWNER!**

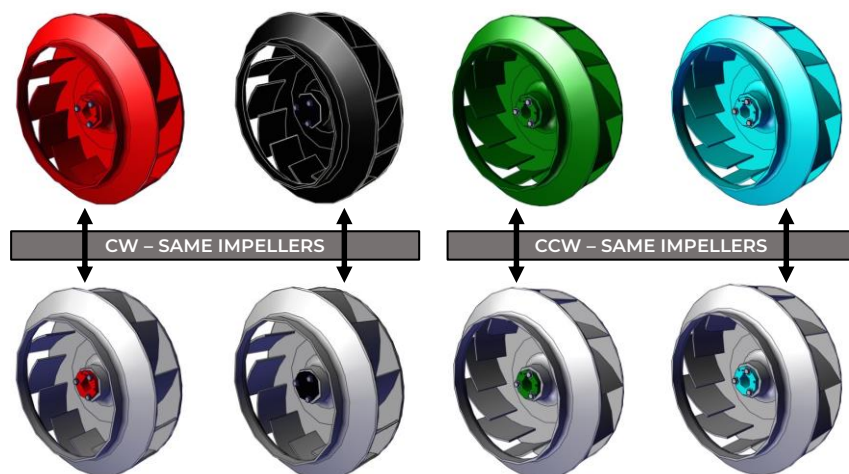

# 1. READ ALL INSTRUCTIONS PRIOR TO OPERATING

## 1.1 CHECKLIST

This manual is a comprehensive step-by-step user instruction guide for the Blower Impeller Replacement and components. To review other manuals, go online to [SonnyDirect.com](http://SonnyDirect.com) under Support Tab.

- Make sure to read, understand and follow all these instructions.
- To address any questions relating to ordering parts, operating the Blower Frame System, installation, troubleshooting, maintenance, service, or anything else, contact Sonny's Technical Support Team at 1-800-327-8723.
- All deviations and alterations from these instructions MUST be reported to Sonny's The CarWash Factory®. Keep this manual in a location where it may be used for ongoing reference.

## 1.2 RECOMMENDED PPE



Eye Protection



Hearing Protection



Gloves



\* Shoes



**\* SHOES:** Toe Protection steel or composite, Impact & Top of Foot Metatarsal Bones Protection up to 75 foot-pounds, Compression Protection up to 2,500 lbs., Electric Shock Resistance up to 600 volts, Antistatic, Puncture Resistant up to 270 lbs., Dielectric Insulation, Slip Resistant Footwear, Conductive Properties to Protect Against Ignition and Volatile Chemicals.

## 1.3 PRECAUTIONS



Stop and read carefully before proceeding, these contain important information to avoid injuries or incorrect equipment installation.

# 1. READ ALL INSTRUCTIONS PRIOR TO OPERATING

## 1.4 IMPORTANT SAFEGUARDS AND WARNINGS

- **WARNING: Do not perform any maintenance or work on equipment unless you first perform Lock-Out Tag-Out Safety Precautions. All electrically powered equipment MUST have manually operated disconnects capable of being locked in the “OFF” position. Equipment that has been “locked out” for any reason must be restarted ONLY by the person who performed the “lock out” operation. These procedures MUST be followed to avoid personal injury, death, and/or dismemberment.**
- All parts and components MUST be installed by experienced and trained technicians.
- No unauthorized personnel should ever be permitted in the wash tunnel or near the equipment at any time.
- Hardhat, safety glasses with side shields, closed steel toe shoes, anti-impact and cut resistant gloves, dust mask, and earplugs if operating power tools, MUST be worn.
- When cutting or grinding any metal, safety glasses, earplugs, and dust mask MUST be worn.
- Do NOT leave a ladder or any other items such as wash down hoses or tools in the wash tunnel while equipment is running. Vehicle damage and injury, including death, can occur.
- Do NOT wear loose fitting clothing or jewelry around moving equipment. Do not allow any part of your body or other objects (including ladders, hoses, or tools) to come in contact with moving equipment. Entanglement may result causing injury, death, or dismemberment.
- Always exercise caution when walking (never run) through the wash tunnel as there may be slippery conditions. Be careful so you do not bump into or trip over equipment.
- Electrical connections and repairs MUST ONLY be performed by a Licensed Electrician.
- Plumbing connections and repairs MUST ONLY be performed by a Licensed Plumber.
- When working on any equipment that is higher than your shoulders, always use a fiberglass ladder that is in good condition.
- Use proper lifting technique. Team lifts are required for items over 50 lbs.
- Do NOT alter or modify parts in any way and do NOT interchange or substitute any components without the authorization of your supervisor and Sonny's The CarWash Factory.
- Do NOT install any parts or components into faulty materials.
- All damages and defects MUST be reported to both your supervisor and Sonny's The CarWash Factory.



# 1. READ ALL INSTRUCTIONS PRIOR TO OPERATING

## 1.4 IMPORTANT SAFEGUARDS AND WARNINGS

- If there are any malfunctions with the **Blower Impeller Replacement**; or if any questions arise regarding the equipment operations, immediately contact your supervisor or Sonny's The CarWash Factory.
- Only use approved hardware, parts, and components with the **Blower Impeller Replacement** or any other equipment.
- Always protect your body parts against sharp corners and edges.
- Keep loose articles of clothing, long hair, and jewelry away from the removal, installation, or operation of all equipment.
- The personnel installing the **Blower Impeller Replacement** are responsible for making sure it works according to the instructions in this manual.
- Always remove ladders, tools, parts, etc., from the wash tunnel and backroom when finished.
- All personnel **MUST** be trained in the safe operation of all equipment, wash tunnel operations, backroom operations, safety regulations, emergency shutdown, Lock-Out Tag-Out and maintenance practices to avoid any accidents, and possible equipment failure.
- Only personnel specifically instructed and trained are permitted to enter the wash tunnel to perform inspections or maintenance. At least two qualified maintenance personnel **MUST** be present when performing equipment repairs or preventive maintenance.
- **IMPORTANT:** Call Technical Support to adjust wash cycle when new equipment is installed.
- **WARNING:** All hydraulic and electrical systems in the wash tunnel equipped with a torque relief or overload should be checked and set to the minimum amount that will allow for proper functionality under normal washing conditions.
- **WARNING:** Possible wet floors and slippery conditions! To avoid an accident that might result in personal injury, death or dismemberment, all personnel **MUST** proceed with Caution.
- **WARNING:** Do NOT enter the wash tunnel when the equipment is operating. Personal injury, death and/or dismemberment may occur.
- **WARNING:** Make sure the proper Chemistry (Brush Lubrication) is being used in the Car Wash Tunnel to prevent vehicle and/or equipment damage.
- **WARNING:** If the Equipment Installation Dimensions at the time of installation are NOT measured correctly, it may result in equipment damage and/or failure. Dimensions **MUST** be verified if equipment is already installed. Contact Sonny's Technical Support Team at 1-800-327-8723 for any Installation questions.

## BLOWER IMPELLER REPLACEMENT OWNER'S MANUAL

# 1. READ ALL INSTRUCTIONS PRIOR TO OPERATING

## 1.4 IMPORTANT SAFEGUARDS AND WARNINGS

- **WARNING:** All connections and repairs MUST ONLY be performed by Licensed Professionals. Perform all trade work in compliance with all applicable local and national codes.
- **WARNING:** Although building codes have been considered in developing all drawings, verification of site-specific conditions and compliance with federal, state, and local building codes is the exclusive responsibility of the customer and/or architect and engineer to verify compliance.
- **WARNING:** Do NOT attempt to repair or adjust any pressurized liquid or pneumatic part, hose, pipe, or fitting while that equipment is in operation.
- **WARNING:** Do NOT operate any equipment that requires safety covers with those covers removed or improperly installed. Do NOT operate any equipment if any component of that equipment is suspected to be defective or malfunctioning.
- **WARNING:** Store all cleaning, washing solutions and oils in a well-ventilated area. Clean up fluid spills immediately to prevent hazardous safety conditions. Be certain to follow all safety procedures on SDS Sheets for each chemical product used.
- **WARNING:** When a piece of equipment must be in operation during inspection or maintenance, one qualified technician must stay at the power disconnect switch while another qualified technician performs the inspection or maintenance.
- **WARNING:** All Equipment MUST be given regular maintenance to prevent equipment damage and/or failure that will VOID the warranty.
- **WARNING:** Emergency "STOP" Buttons MUST be well marked, and their location and proper use reviewed with all personnel. Any activated "STOP" button must be reset only by the person who activated it. Clear the wash tunnel of any people, ladders, hoses, tools, and other loose items before restarting the equipment. An audible device MUST sound to warn people that the equipment is starting.

## SAVE THESE INSTRUCTIONS

---

## 1.5 SAFETY FIRST

- **CAUTION:** Verify Safe Working Conditions
- Make sure to Have a Safety Kit Before Starting Equipment Installation, Service or Repairs
- Make Sure to Apply the Lock-Out Tag-Out to Any Equipment that Requires it
- Your Equipment Should Always be Installed by a Qualified Technician



# 1. READ ALL INSTRUCTIONS PRIOR TO OPERATING

## 1.6 HOW TO MAKE A SAFE WORKPLACE

- 1 Wear Appropriate Attire
  - 2 Wear Safety Equipment
  - 3 Keep Aisles Clear
  - 4 Keep Work Area Clean
  - 5 Report Accidents
  - 6 Report Any Unsafe Conditions
  - 7 Place Trash In Proper Containers
  - 8 No Smoking In Tunnel Or Backroom
  - 9 Have a First Aid Kit For Emergencies
  - 10 Have a Fire Extinguisher On Site
  - 11 Lift Properly
  - 12 Power Off For Install & Service
- 
- 

## 1.7 LADDER SAFETY

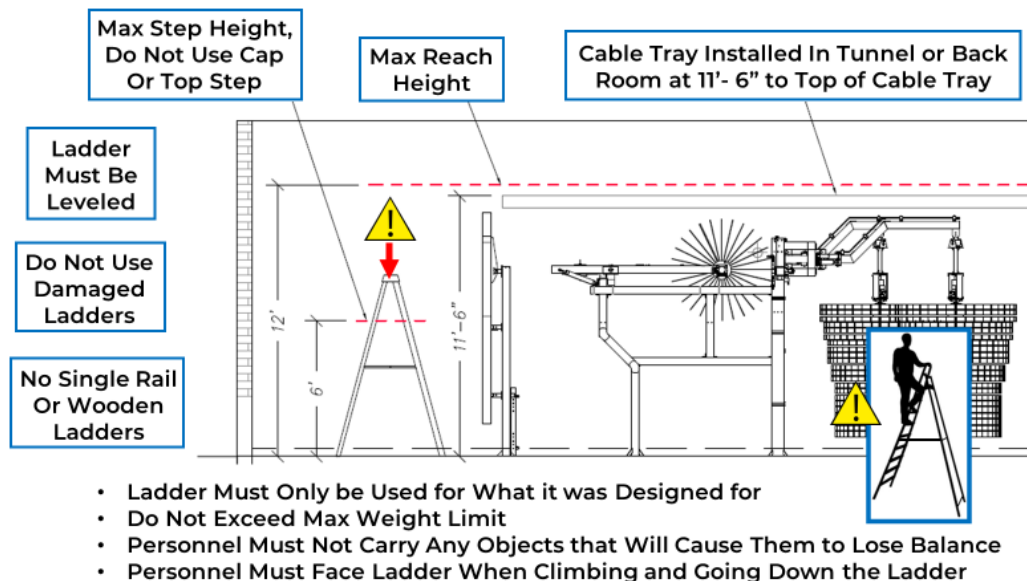

## BLOWER IMPELLER REPLACEMENT OWNER'S MANUAL

# 1. READ ALL INSTRUCTIONS PRIOR TO OPERATING

## 1.8 OWNER'S MANUAL UPDATES

### Revisions F, G and H Updates to Installation Manual

- 1 Added: Impeller Color Changes (F)
- 2 Added: Impeller Label Removal (G)
- 3 Added: Loosen Set Screw on Taper Lock (H)

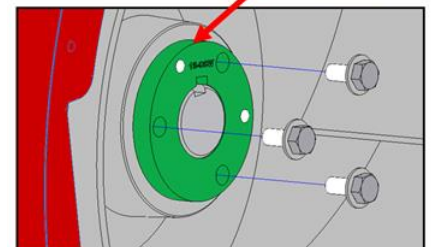
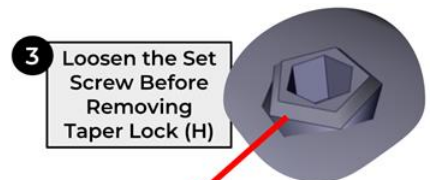
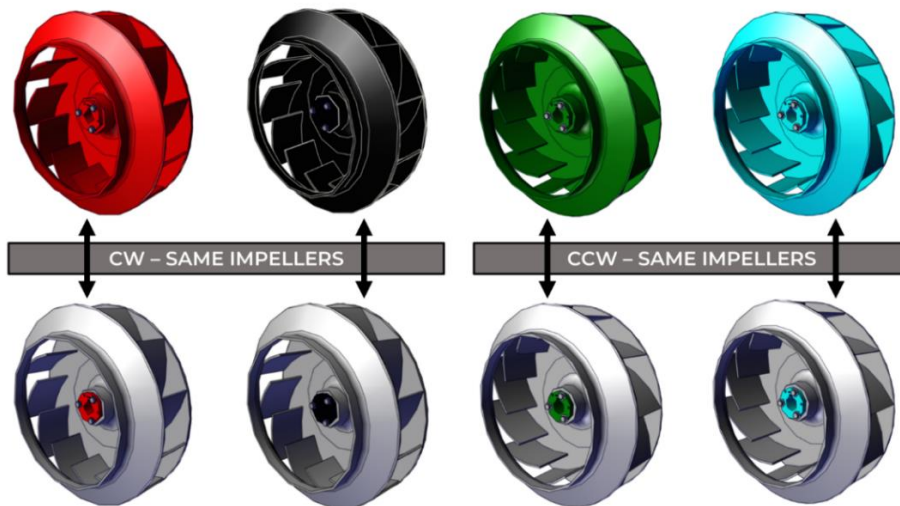
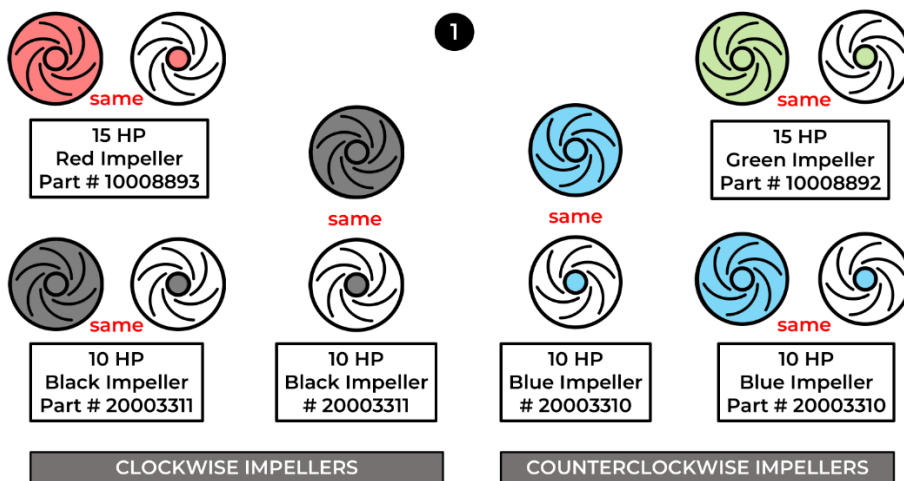

## 2. BLOWER IMPELLER REPLACEMENT FEATURES

### 2.1 INTRODUCTION

Sonny's Blower Impellers move large volumes of air in a radial direction on the concave side of the impeller blade for an intense air blast output that dries vehicles efficiently and fast.

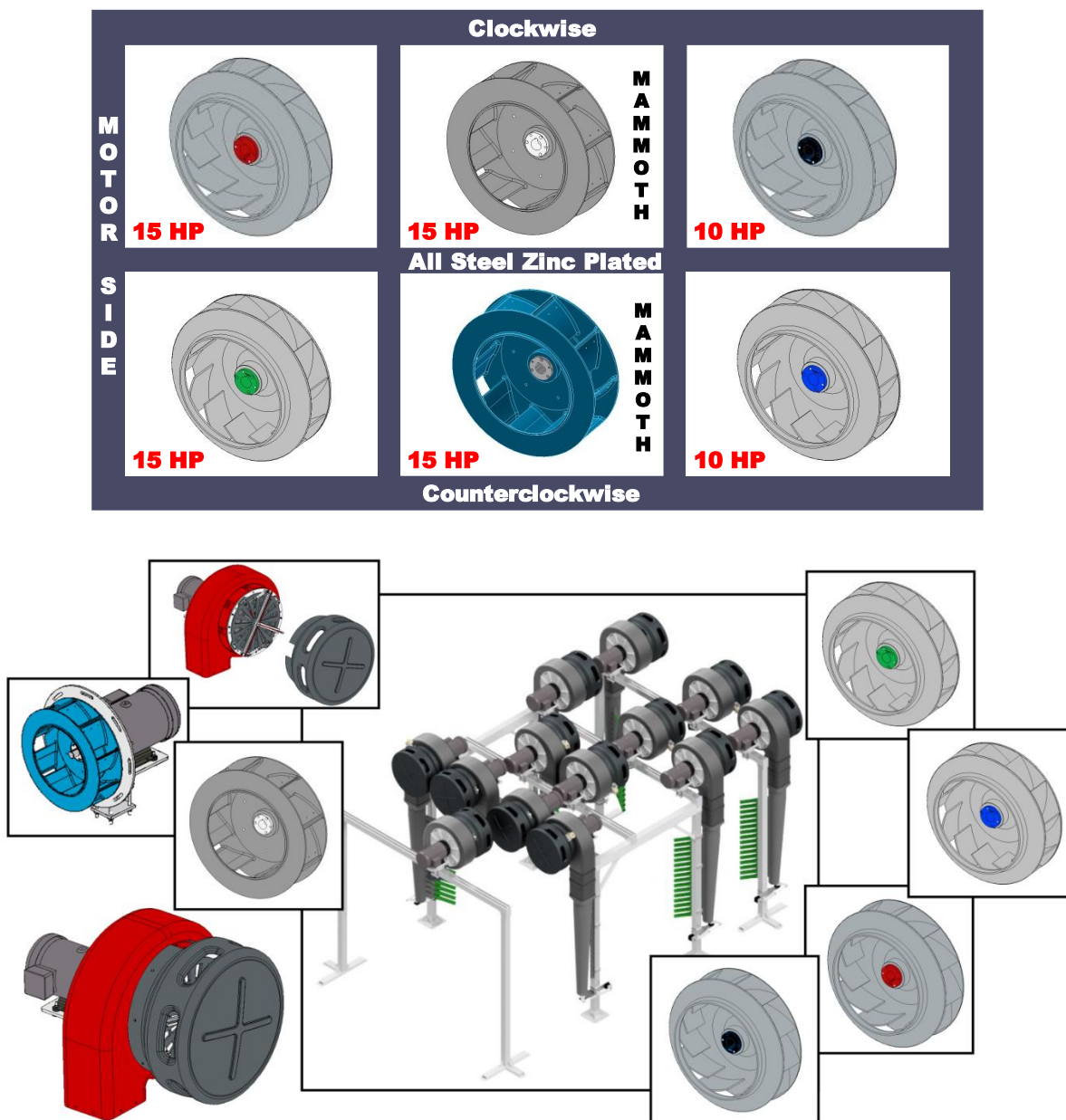

## BLOWER IMPELLER REPLACEMENT OWNER'S MANUAL

## 2. BLOWER IMPELLER REPLACEMENT FEATURES

### 2.2 EQUIPMENT SPECIFICATIONS

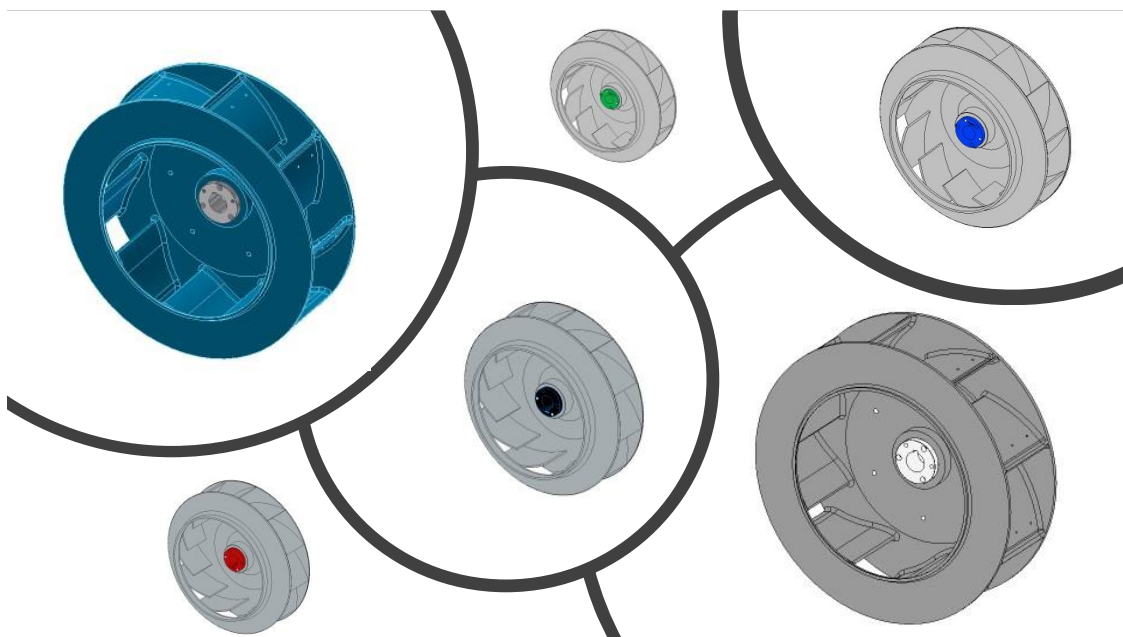

1	Impeller Diameter	19 ¼"
2	Type	OEM Parts
3	Brand	Sonny's
4	Impeller Material	Steel Zinc Plated

## 3. UTILITY REQUIREMENTS

### 3.1 UTILITIES

Utilities interconnection and the materials required for interconnection to Sonny's equipment are the responsibility of the customer.



All connections and repairs MUST ONLY be performed by Licensed Professionals. Perform all trade work in compliance with all applicable local and national codes.



**CAUTION:** Do not use wire nuts to connect 3 phase wiring at the electric motor terminal box. Only use split bolt type connectors with electrical insulation tape and rubber insulator boots.

#### Compressed Air - The Customer's Plumber is responsible for:

- The installer is to provide materials and install a 3/8" compressed air line from the Air Compressor to and from the supplied air regulator, 4-way air solenoid valves, and air cylinder on the Dryer Producer Assembly. Compressed Air requirement is approximately 1.5CFM at 60PSI.

#### Electric - The Customer's Electrician is responsible for:

- The Customer's Electrician is to provide materials and install single phase power from the Customer's equipment programmer (Equipment Start-Stop System) to the actuation controls for each electric motor on the Blower.
- The Customer's Electrician is to provide materials and install 3-phase power (see voltage options below) to the Blowers Electric Motors on the Blower Frame System through properly sized 3 pole circuit breakers and motor starters with 3 thermal overloads.
- WARNING:** Make sure all motors are properly wired for the supply voltage being used.

#### Voltage Options

- 208V / 3-Phase / 60 Hz
- 230V – 460V / 3-Phase / 60 Hz
- 190V – 380V / 3-Phase / 50 Hz

**AeroGate™ Operating Pressure:  
20psi**

**Flip V-Nozzle Operating  
Pressure: 20 - 30psi**

**Pivoting Mammoth Cylinder  
Operating Pressure: 30psi**



#### Technical Disclaimer

Although building codes have been considered in developing all drawings, verification of site-specific conditions and compliance with federal, state, and local building codes, it is the exclusive responsibility of the customer and/or architect and engineer to verify compliance.

## 4. INSTALLATION INSTRUCTIONS

### 4.1 SAFETY WEAR REQUIRED FOR INSTALLATION



**WARNING:** Make sure to follow Local and State Safety Wear Required Regulations to ensure the safety of all personnel. Failure to follow Safety Regulations may result in personal injury, death, and/or dismemberment.

### 4.2 EQUIPMENT REQUIRED FOR INSTALLATION

EQUIPMENT
2 Ladders 8'

### 4.3 TOOLS REQUIRED FOR INSTALLATION

TOOLS	TOOLS
Impact Gun with Socket Set	1/8" Allen Key
1/2" Drive Ratchet Set	Penetrating Oil
Standard Combo Wrench Set	Blower Impeller Removal Tool
Torque Wrenches	Bearing Punch
3lb Sledgehammer	WD-40®
Jaw Puller	Anti-Seize Compound Never-Seez®

### 4.4 BLOWER IMPELLER REPLACEMENT DOCUMENTS

CLICK QR CODE



SCAN ME

Install Manual

CLICK QR CODE



SCAN ME

Equipment Docs



## 4. INSTALLATION INSTRUCTIONS

### 4.5 INSTALLATION IMPELLER OPTIONS

Install the Correct Blowers on the Beam Frame. Only use the given Impeller Options per position on the Frame to ensure Blower optimization. **Torque U-Bolts to 57 ft-lb.**

#### IMPELLER OPTIONS

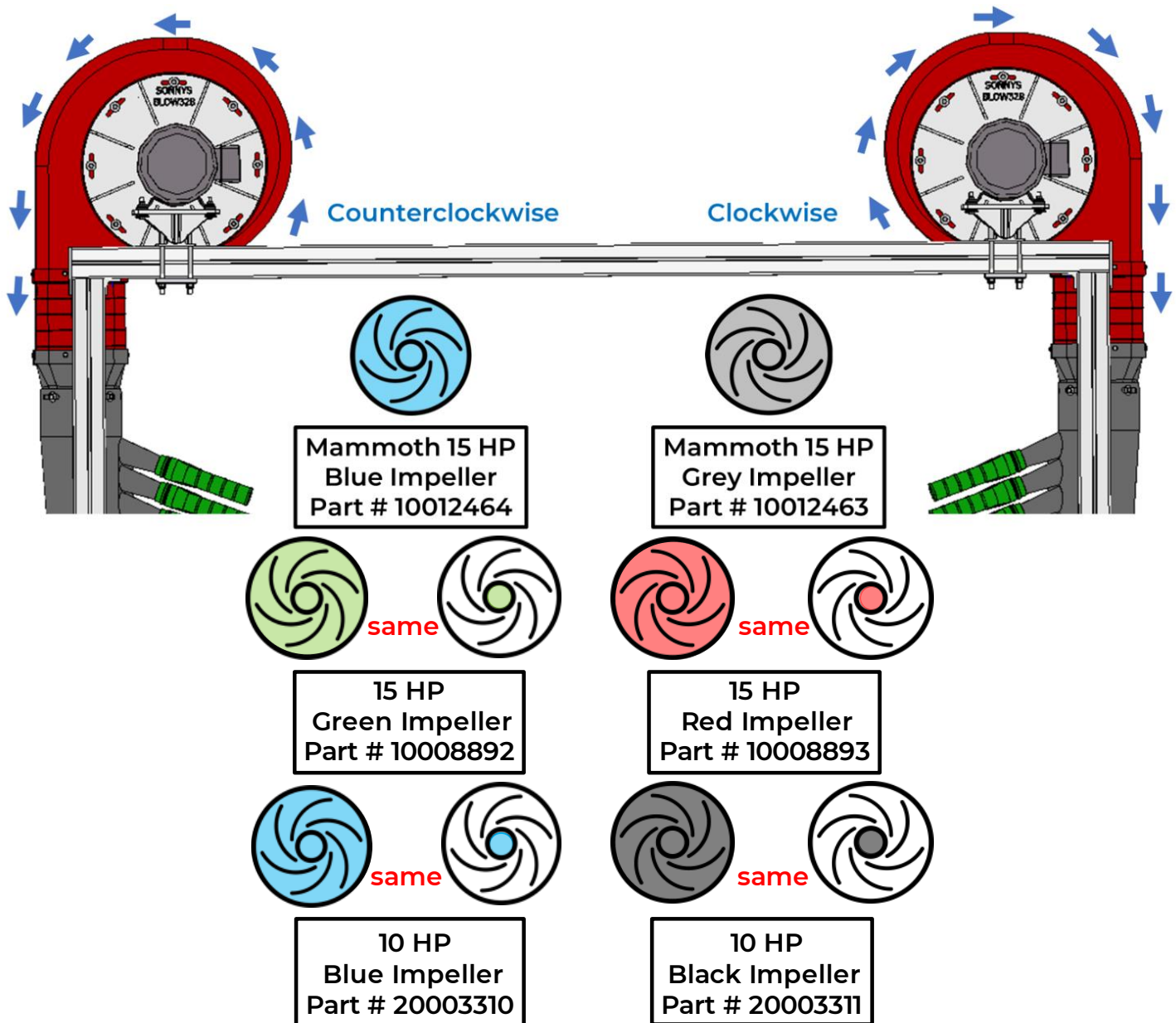

## BLOWER IMPELLER REPLACEMENT OWNER'S MANUAL

## 4. INSTALLATION INSTRUCTIONS

### 4.6 INSTALLATION IMPELLER OPTIONS

Install the Correct Blowers on the Beam Frame. Only use the given Impeller Options per position on the Frame to ensure Blower optimization. **Torque U-Bolts to 57 ft-lb.**

#### IMPELLER OPTIONS

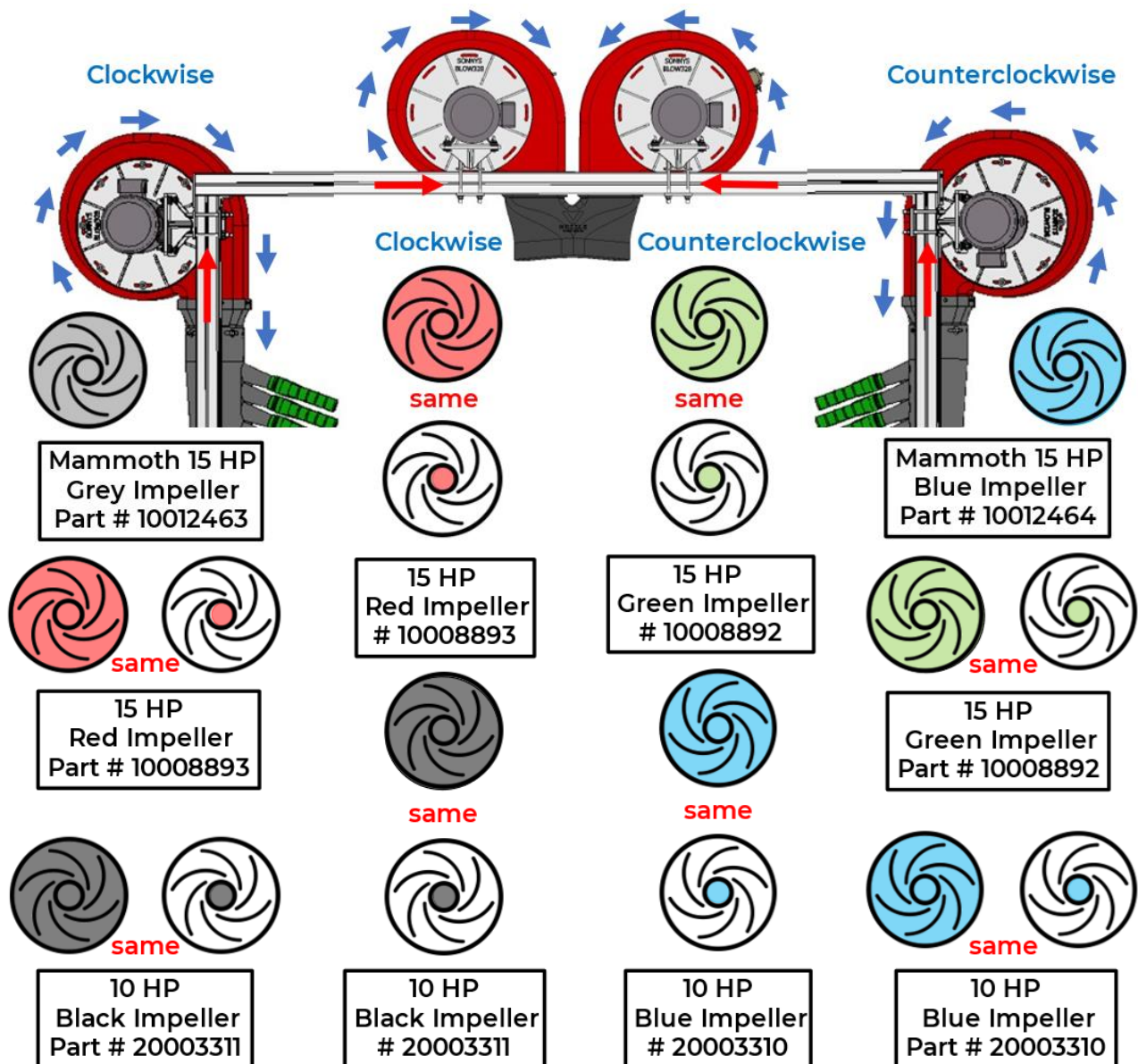

## 4. INSTALLATION INSTRUCTIONS

### 4.7 BEFORE STARTING



**IMPORTANT:** All parts and components **MUST** be installed by experienced and trained technicians. Safety wear is required for ALL personnel.

WORK FORCE	INSTALLATION TIME
2 Experience and Trained Technicians	1 to 3 Hours for Replacement

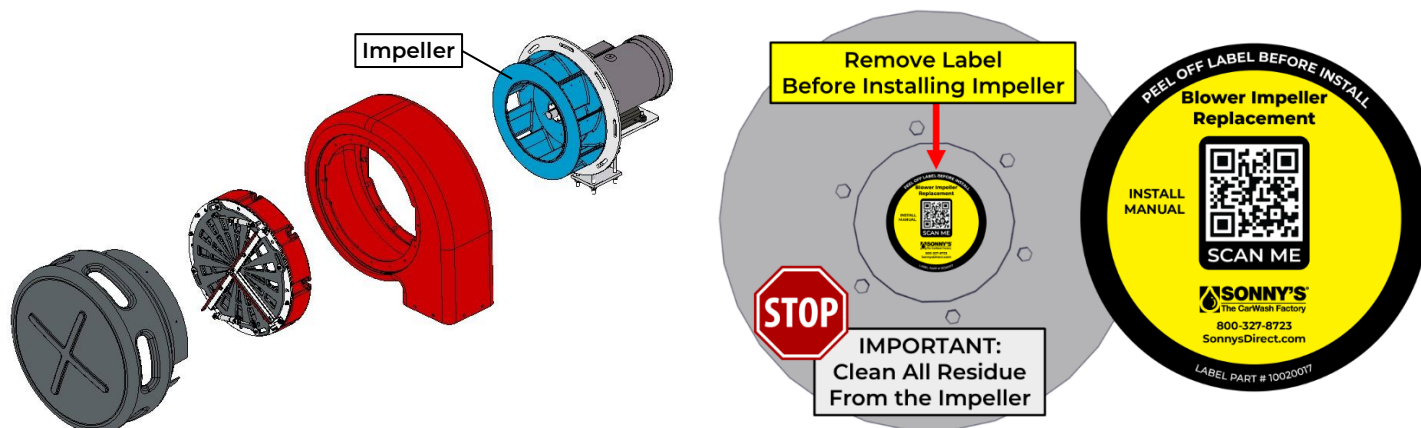

**IMPORTANT:** If the Equipment Installation Dimensions at the time of installation are **NOT** measured correctly, it may result in equipment damage and/or failure.



**DANGER:** Always shutoff all power to conveyor and/or equipment before starting any install, maintenance, service, or repairs. Failure to do this may result in personal injury, death, or dismemberment.

## BLOWER IMPELLER REPLACEMENT OWNER'S MANUAL

## 4. INSTALLATION INSTRUCTIONS

### 4.8 REMOVE – BLOWER SILENCER OPTIONAL

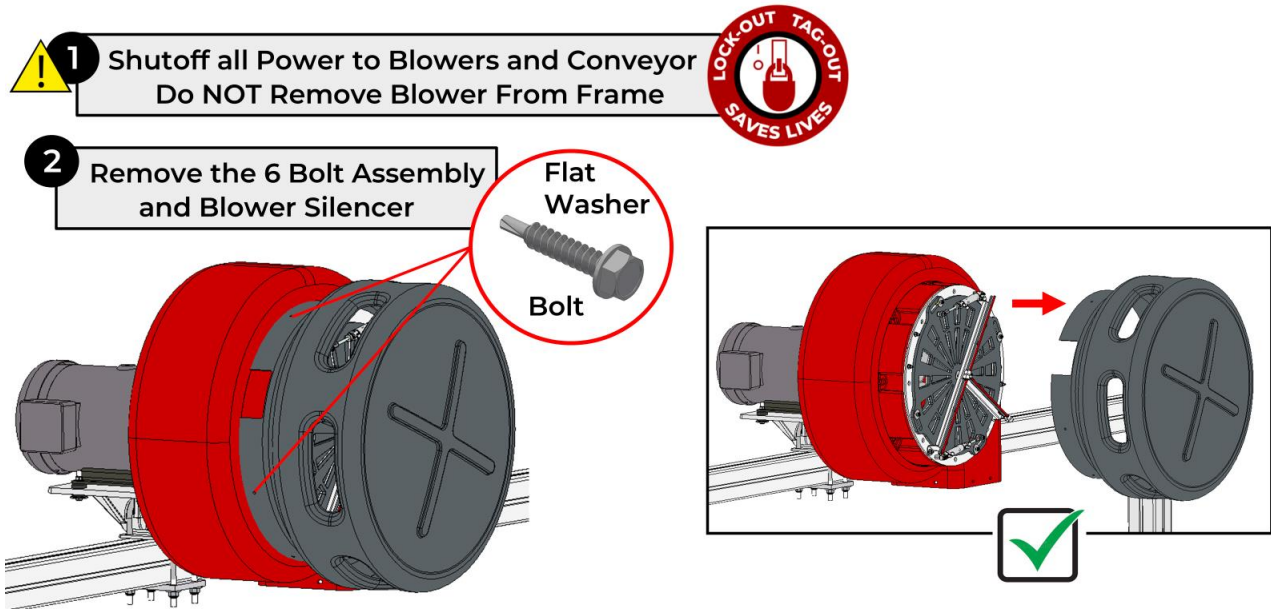

### 4.9 REMOVE – AEROGATE AND VENTURI

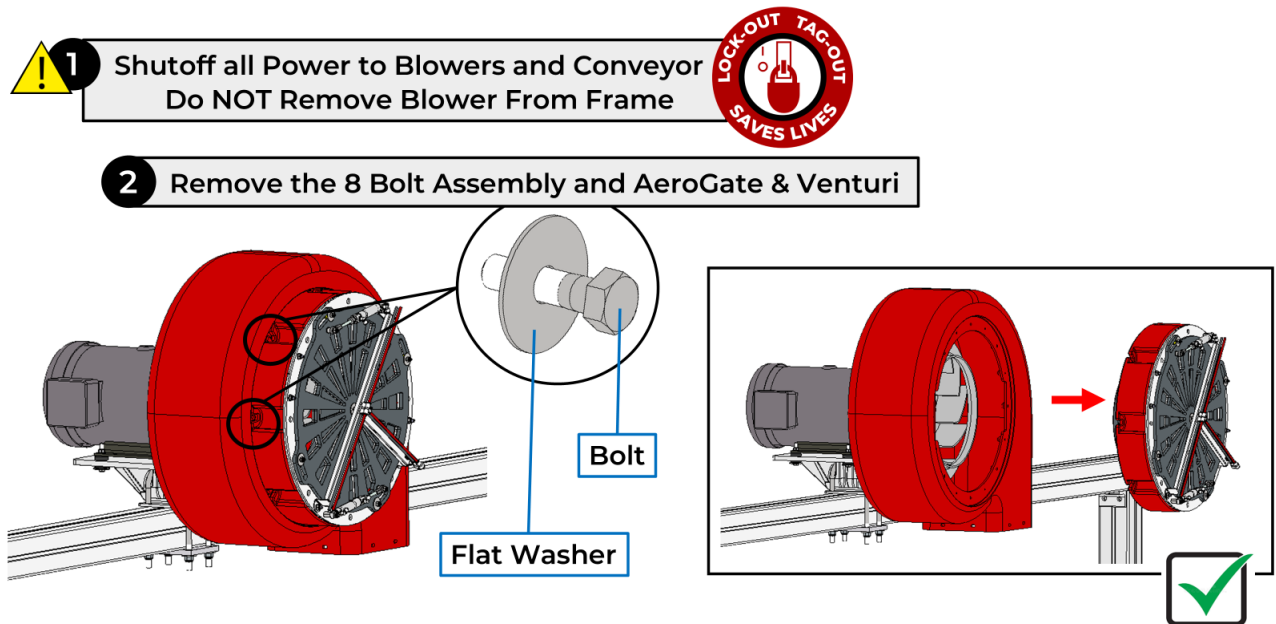



## 4. INSTALLATION INSTRUCTIONS

### 4.10 REMOVE – VENTURI

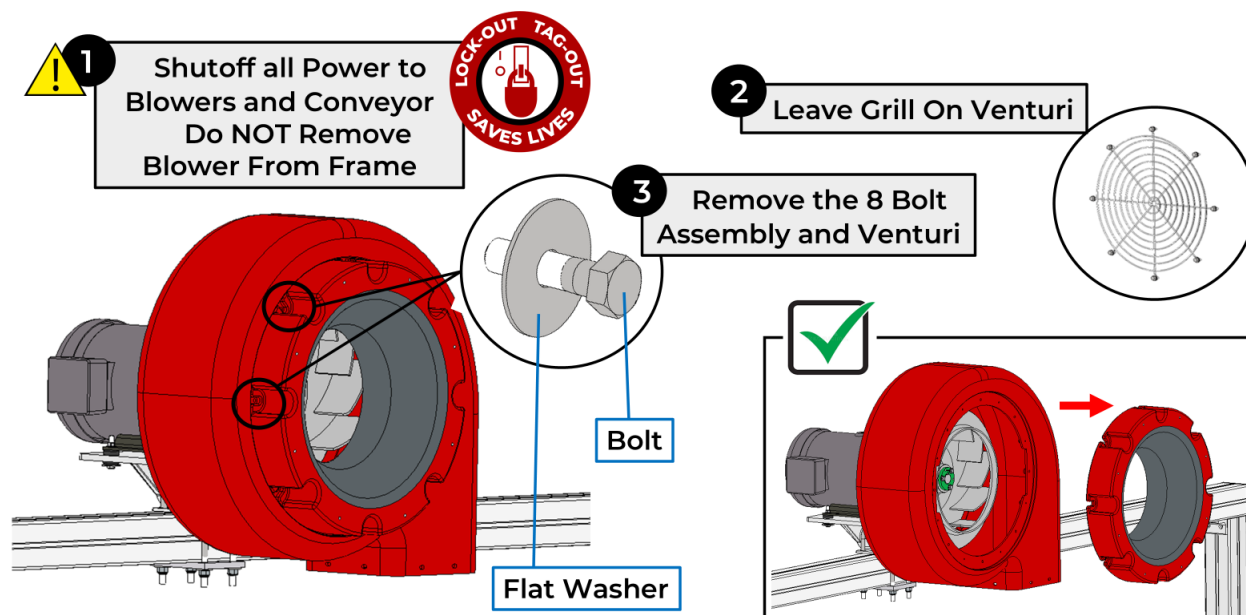

### 4.11 REMOVE – GATOR

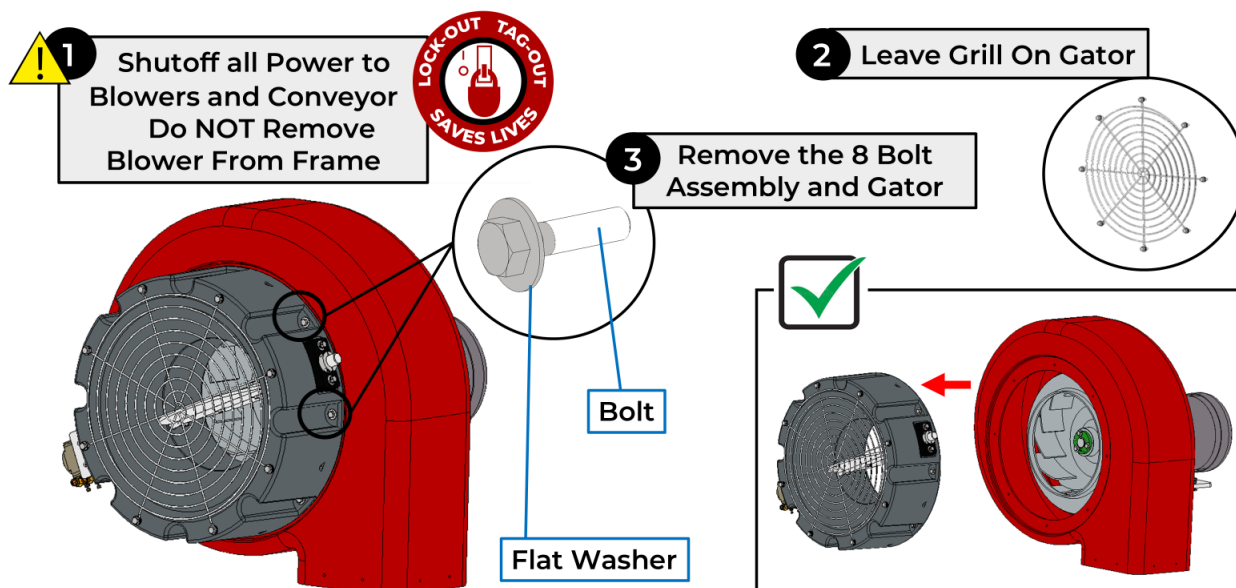

## 4. INSTALLATION INSTRUCTIONS

### 4.12 REMOVE – IMPELLER

- 1** Shutoff all Power to Blowers and Conveyor  
Do NOT Remove Blower From Frame

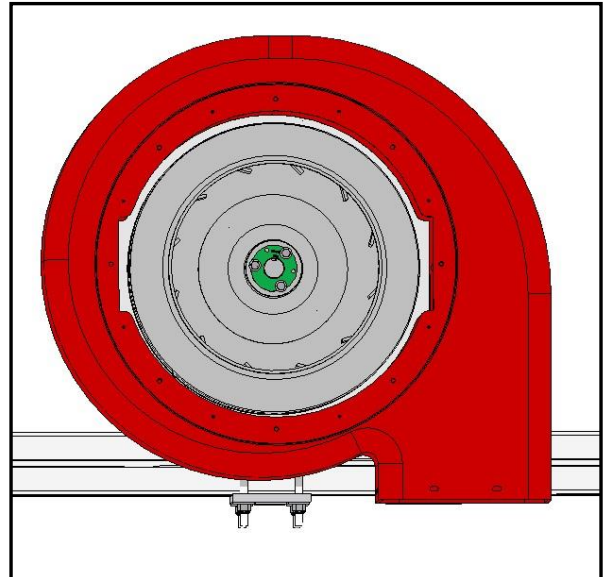
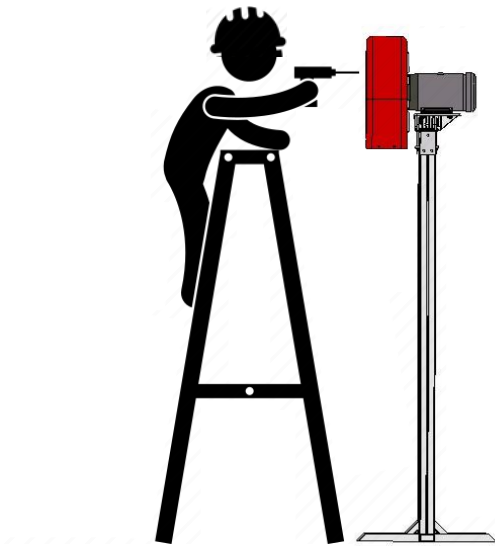

- 2** Apply a Generous Amount  
of Penetrating Oil Onto the  
Taper Lock Bushing

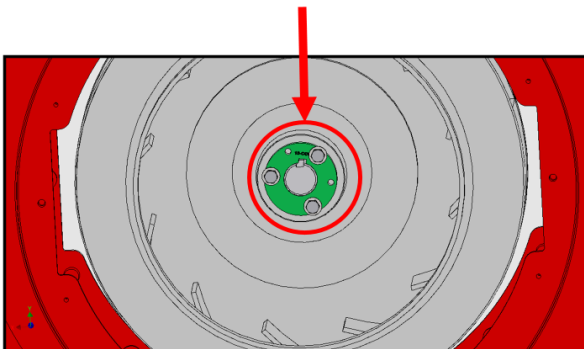

- 4** Remove the 3 Bolt Assembly  
and Loosen the Set Screw  
with 1/8" Allen Key

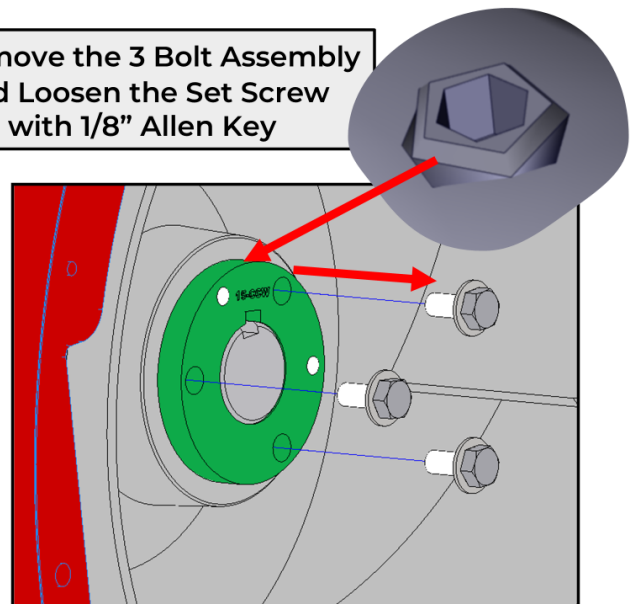

- 3** Note Position of  
Impeller on Shaft



## 4. INSTALLATION INSTRUCTIONS

### 4.12 REMOVE – IMPELLER

- 5** Insert 2 of the Bolts Removed Into the 2 Threaded Holes and Alternate Tightening Them Down

**!**  
Clean  
Bolts and  
Holes With  
WD-40®

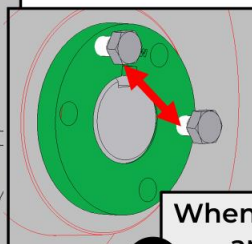
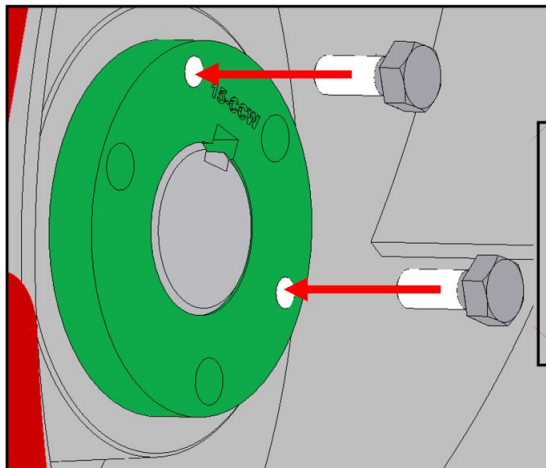

- 6** When the Taper Lock Bushing and Impeller Separate, Unscrew the 2 Bolts Out to Equal Distance

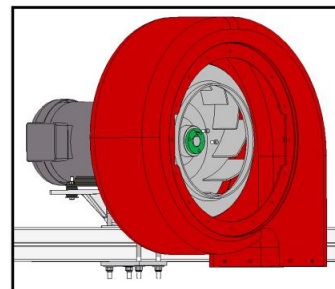

**OR**

- 5** Place the Opening of **Blower Impeller Removal Tool** Over the Taper Lock Bushing and Flat Against the Impeller Surface

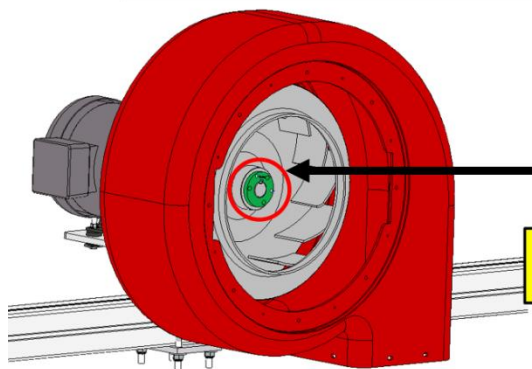

Order Part  
# 20018599

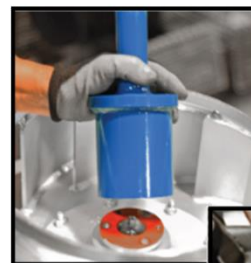

- 6** With Hand Firmly Around the Base Handle, Hit the Tool Several Times With Hammer, Impeller Completely Separates From Taper Lock

## BLOWER IMPELLER REPLACEMENT OWNER'S MANUAL

## 5. INSTALLATION INSTRUCTIONS

### 4.12 REMOVE – IMPELLER

- 7** Pull the Impeller Towards You Until the Taper Lock Bushing Comes Off the Shaft

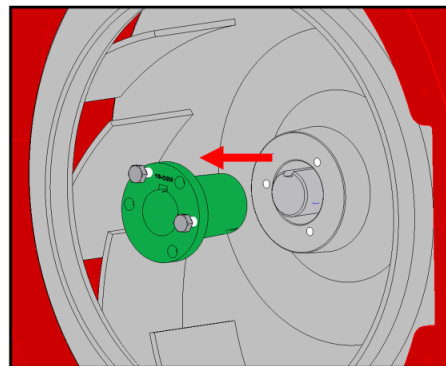
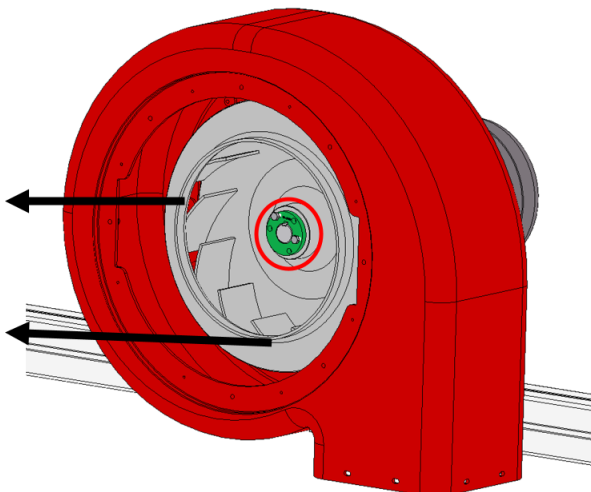

- 8** Pull and Remove the Taper Lock Bushing

OR

- 7** Insert the **Jaw Puller** Under the Taper Lock Bushing and Use a Wrench to Twist **Jaw Puller Screw** Clockwise Against Shaft to Remove Taper Lock From Shaft

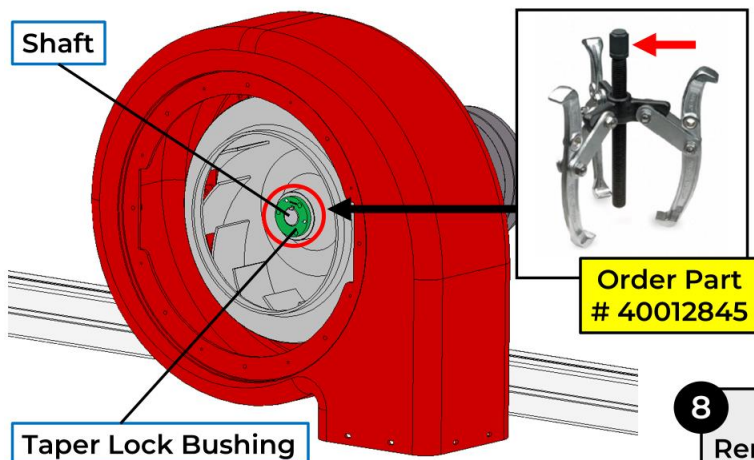

- 8** Pull On the **Jaw Puller** and Remove the Taper Lock Bushing

## 4. INSTALLATION INSTRUCTIONS

### 4.12 REMOVE – IMPELLER

#### 9 Remove Old Impeller

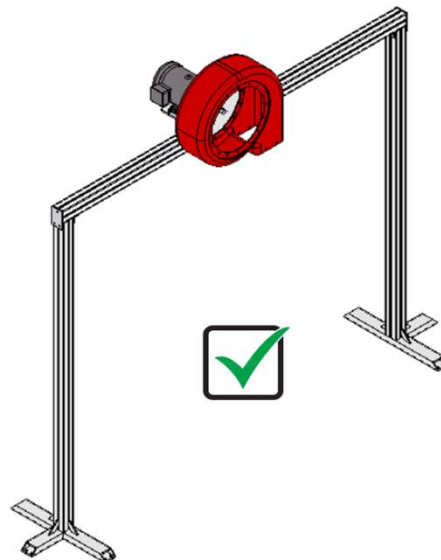
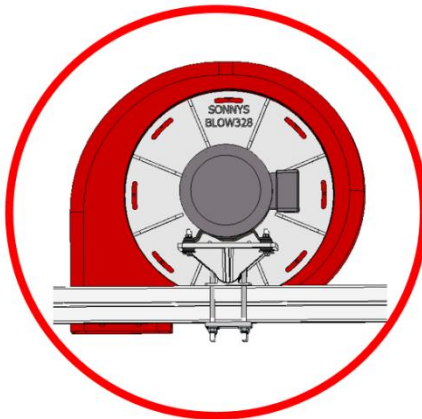
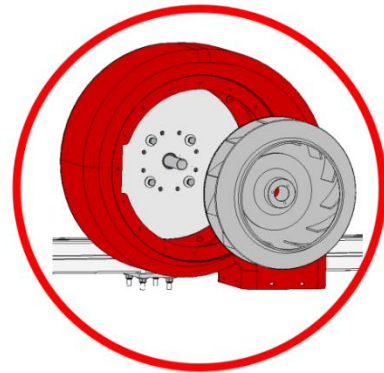
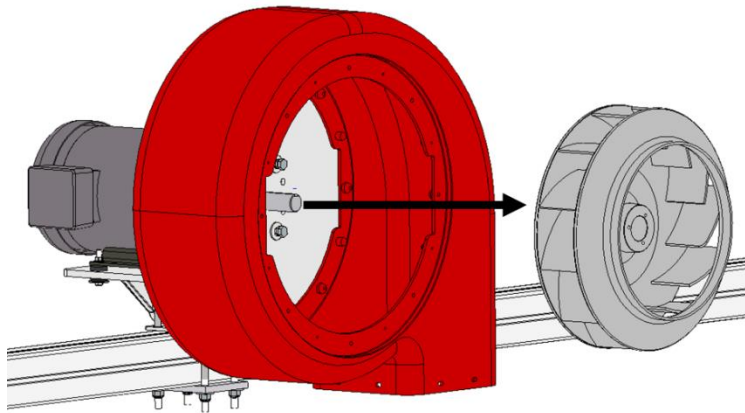

## 4. INSTALLATION INSTRUCTIONS

### 4.13 INSTALL NEW IMPELLER

**1** Insert Key Stock Into Shaft Groove

**2** Remove Label Before Installing Impeller

**3** Install NEW Impeller

**4** Align Groove On Taper Lock Bushing With Shaft Groove, Stock Key and Insert Taper Lock Halfway

**5** Align Impeller Bolt Holes With Taper Lock Holes

**6** Insert Taper Lock All the Way In

**LOCK-OUT TAG-OUT SAVES LIVES**

**STOP** IMPORTANT: Clean All Residue From the Impeller

**Verify With Impeller Options Section**

The diagram illustrates the six steps for installing a new impeller. Step 1 shows a key stock being inserted into a shaft groove, with a 'LOCK-OUT TAG-OUT SAVES LIVES' warning. Step 2 shows a yellow label being removed from the impeller. Step 3 shows the new impeller being installed, with a warning to 'Verify With Impeller Options Section'. Step 4 shows the impeller being aligned with the shaft, with a 'STOP' sign and 'IMPORTANT: Clean All Residue From the Impeller' instruction. Step 5 shows the impeller being aligned with the taper lock holes. Step 6 shows the taper lock being inserted all the way in. A final checkmark indicates the installation is complete.



## 4. INSTALLATION INSTRUCTIONS

### 4.13 INSTALL NEW IMPELLER

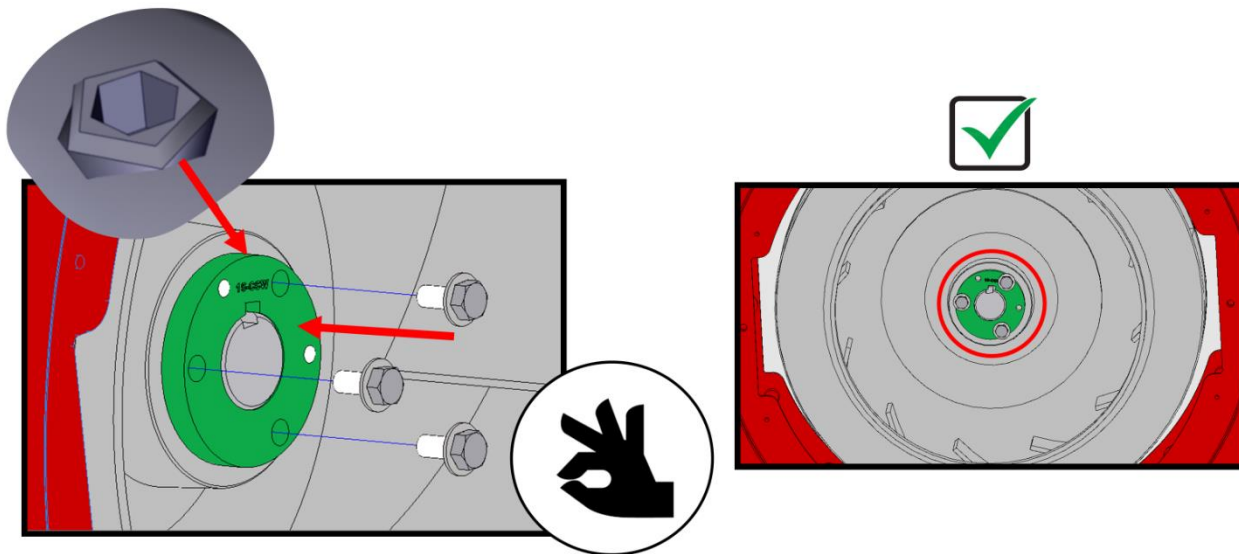

**7** Insert the 3 Bolt Assembly and Tighten the Set Screw with 1/8" Allen Key

**8** Use a Torque Wrench to Alternate Tightening Bolts In a Circular Motion

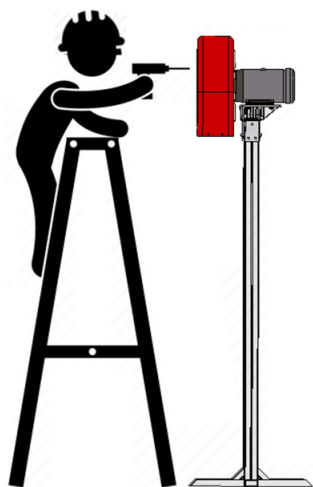

**Torque To 18 ft-lb**

**9** Spin Impeller, If It Comes In Contact With Back Plate Adjust Until It Does Not

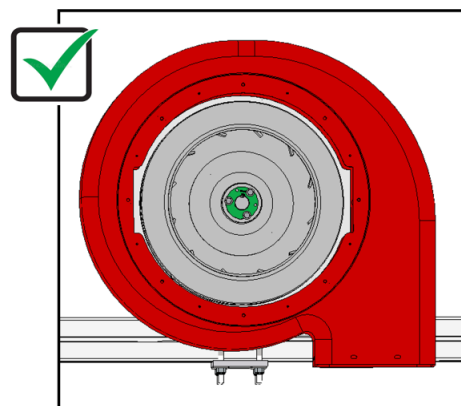

## 4. INSTALLATION INSTRUCTIONS

### 4.14 INSTALL AEROGATE AND VENTURI

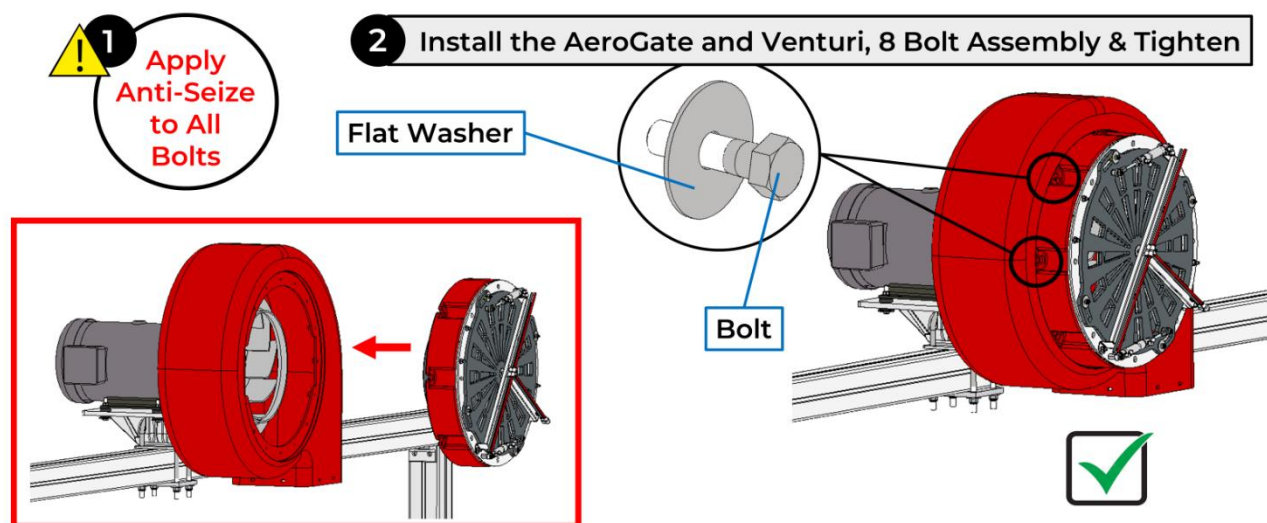

### 4.15 INSTALL VENTURI

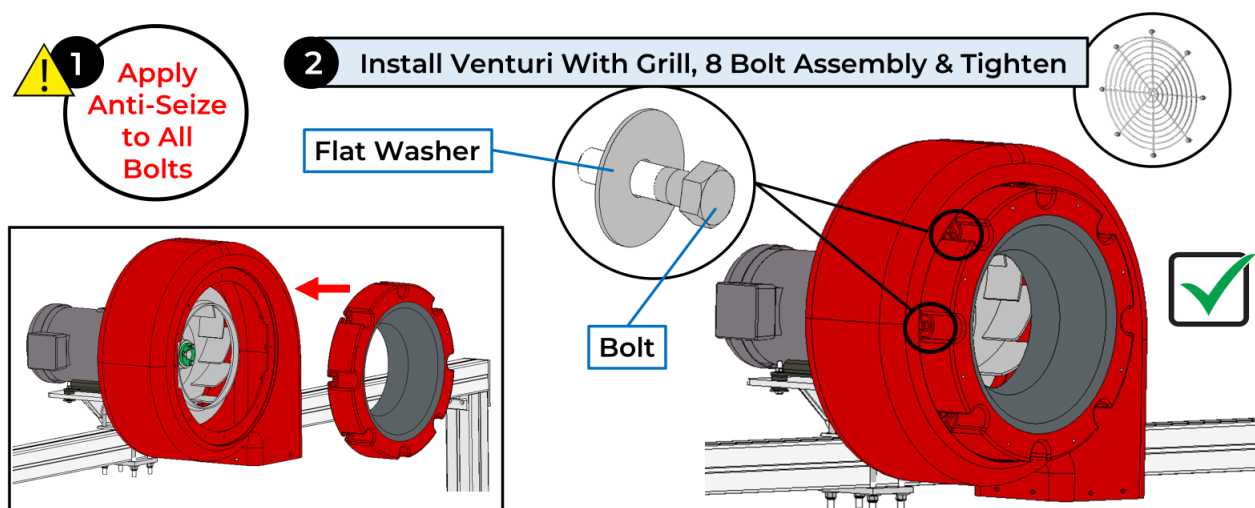



## 4. INSTALLATION INSTRUCTIONS

### 4.16 INSTALL BLOWER SILENCER OPTIONAL

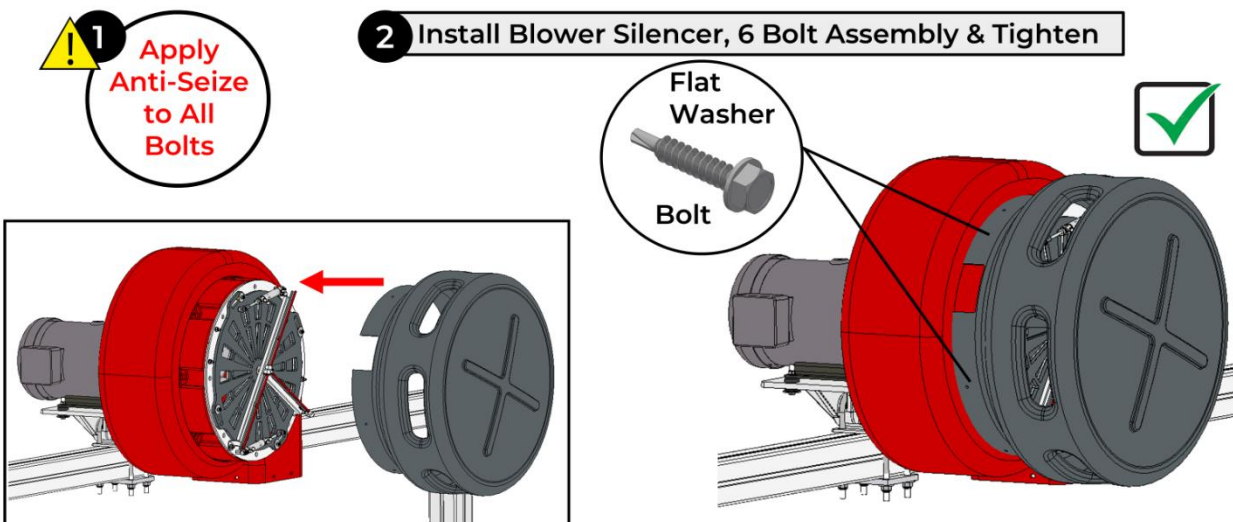

### 4.17 INSTALL GATOR

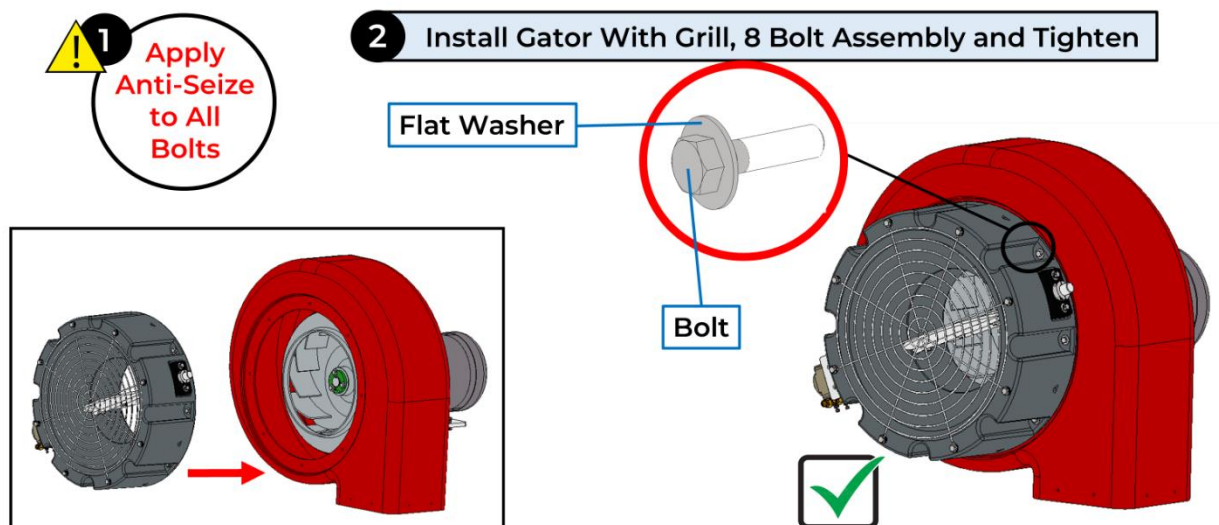

## 4. INSTALLATION INSTRUCTIONS

### 4.18 REMOVE LOCK-OUT TAG-OUT

**1** Remove ALL Tools & Equipment From Tunnel



**3** **IMPORTANT:** Clear ALL Personnel From Tunnel

**4** Remove LOCK-OUT TAG-OUT



**5** Restore Power to Blowers and Conveyor

**6** Listen For Any Unusual Noises

## 5. MAINTENANCE

**IMPORTANT:** For the first month of operation check all hardware and fittings for tightness each week!



**WARNING:** Make sure the proper Chemistry (Brush Lubrication) is being used in the Car Wash Tunnel to prevent vehicle and equipment damage.

### 5.1 DAILY

- Check each producer for proper operation, listening for any unusual noises and correct the cause of any unusual vibration.
- Remove any debris from the air inlet screen on the air producers.
- Check the optional top oscillator or flip nozzle for proper operation.
- Wipe or wash down blower silencers, blower housings, and nozzles.
- Check nozzle outlets and blower silencer for debris or obstructions.

### 5.2 MONTHLY

- Inspect all hardware and fittings for tightness.
- Thoroughly clean the framework, blower silencers, blower housings and each impeller of dirt and debris.
- Check bolted connections to ensure they are tight.
- Check for damaged blower silencers.
- Check grating surrounding conveyor for wear and sturdiness, replace as needed. Do NOT stand on it to avoid injuries.

### 5.3 ANNUALLY

- Measure and Record Full Load Amp Readings.
- Measure and record, full load current readings from each of the three legs of each of the three phase electric motors.
- If the differential of current load exceeds 10% between the legs, or the balanced load current of all three legs has increased over 10% since the most recent measurements, order a replacement motor.
- Record readings in the semi-annual log.
- Grease all electrical motors on the blowers with a high-temperature grease, rated for at least 160 degree Fahrenheit.

## 6. ONLINE SERVICES

NOTE: Click or Scan QR Code

### 6.1 SHOP



### 6.2 QUICK ORDER



### 6.3 TRACK ORDER



### 6.4 SALES



### 6.5 SERVICE & SUPPORT

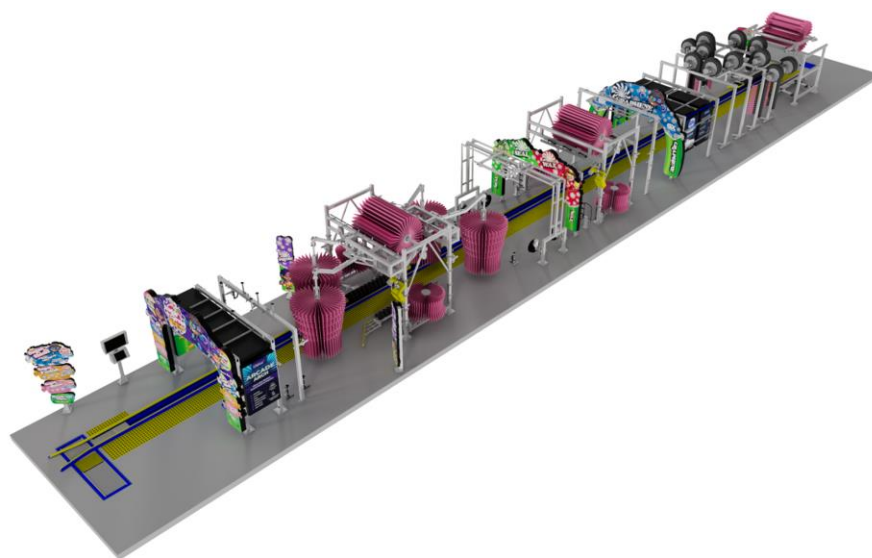

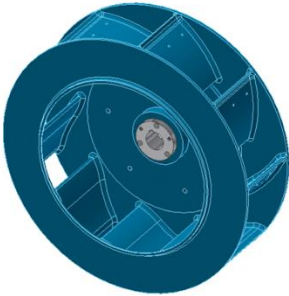
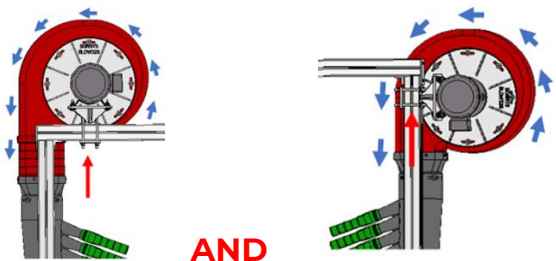
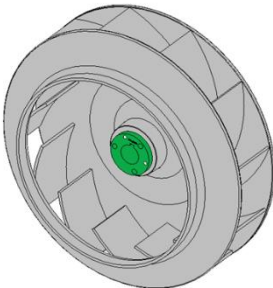
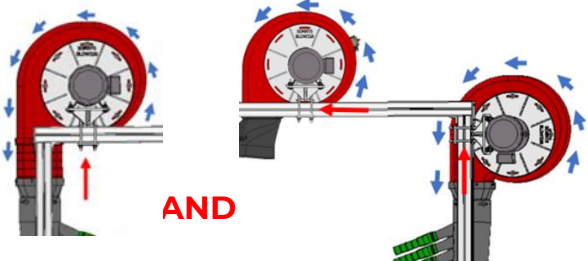
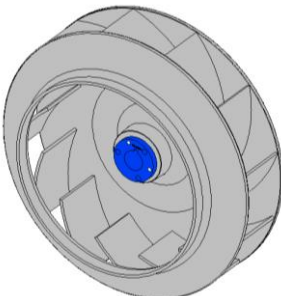
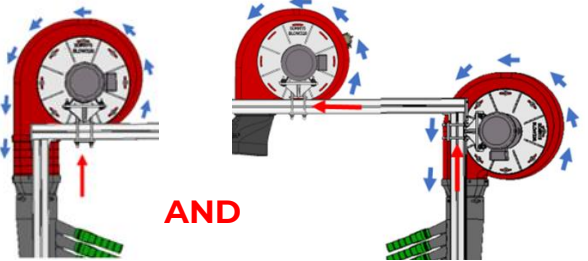

## 7. WEAR ITEMS AND REPLACEMENT PARTS

### 7.1 COUNTERCLOCKWISE IMPELLERS – FROM MOTOR SIDE

Part Number	Image	Description
10012464		<p><b>Mammoth 15 HP Blue Impeller</b></p> 
10008892		<p><b>15 HP Green Center Impeller</b></p> 
20003310		<p><b>10 HP Blue Center Impeller</b></p> 

## 7. WEAR ITEMS AND REPLACEMENT PARTS

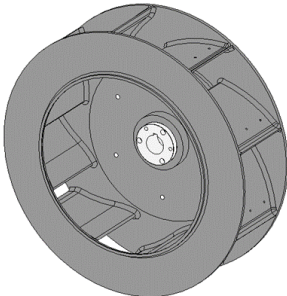
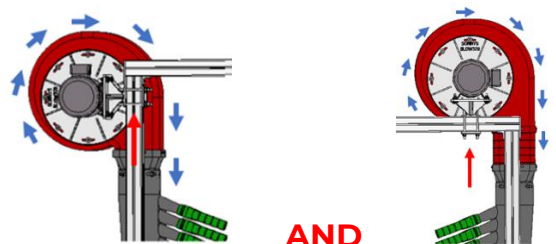
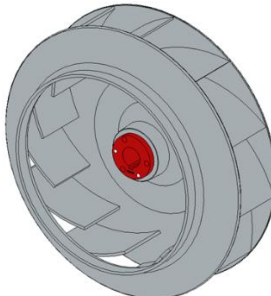
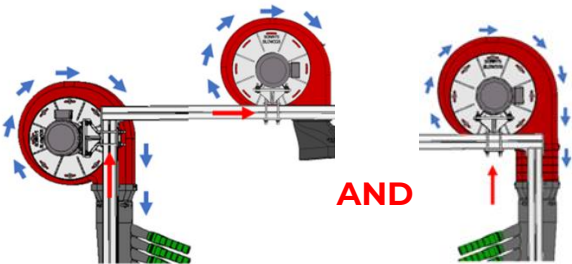
### 7.2 CLOCKWISE IMPELLERS – FROM MOTOR SIDE

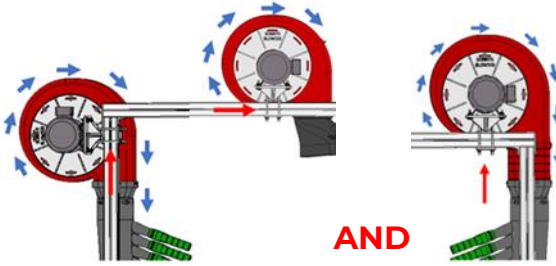
Part Number	Image	Description
10012463		<p><b>Mammoth 15 HP Grey Impeller</b></p> 
10008893		<p><b>15 HP Red Center Impeller</b></p> 
20003311		<p><b>10 HP Black Center Impeller</b></p> 



## 8. CONTACT US

### 8.1 TECHNICAL SUPPORT

For questions regarding installation, operational issues, settings, or servicing of this equipment, please contact Sonny's Technical Support Team:

Email: [Sonnys-Support@SonnysDirect.com](mailto:Sonnys-Support@SonnysDirect.com)

SMS Text: 954-406-4363

Phone: 800-327-8723 Option #5

### 8.2 REPLACEMENT PARTS

Shop Online: <https://sonnysdirect.com/shop/>

Email: [CustomerService@SonnysDirect.com](mailto:CustomerService@SonnysDirect.com)

Phone: 800-327-8723 Option #3

### 8.3 SCHEDULE ON-SITE SERVICE AND SUPPORT

Online: <https://sonnysdirect.com/services>

Florida	407-770-1000	Email: SCWSFLservice@sonnysdirect.com
Southeast	770-995-5989	Email: CWSseservice@sonnysdirect.com
Mid-Atlantic	800-448-4735	Email: Service-ma@sonnysdirect.com
Northeast	866-343-6680	Email: SCWSNEservice@sonnysdirect.com
Midwest	800-274-2777	Email: Service-indy@sonnysdirect.com
Texas	800-826-0829	Email: SCWStxservice@sonnysdirect.com
West	833-725-6353	Email: SCWSservice@sonnysdirect.com
All Others	800-327-8723	

### 8.4 EMERGENCY CELL PHONE CONTACTS



<https://sonnysdirect.com/emergency>

## BLOWER IMPELLER REPLACEMENT OWNER'S MANUAL

